

Diagrams and Parts List

IK-12MAX

Torch SP-100

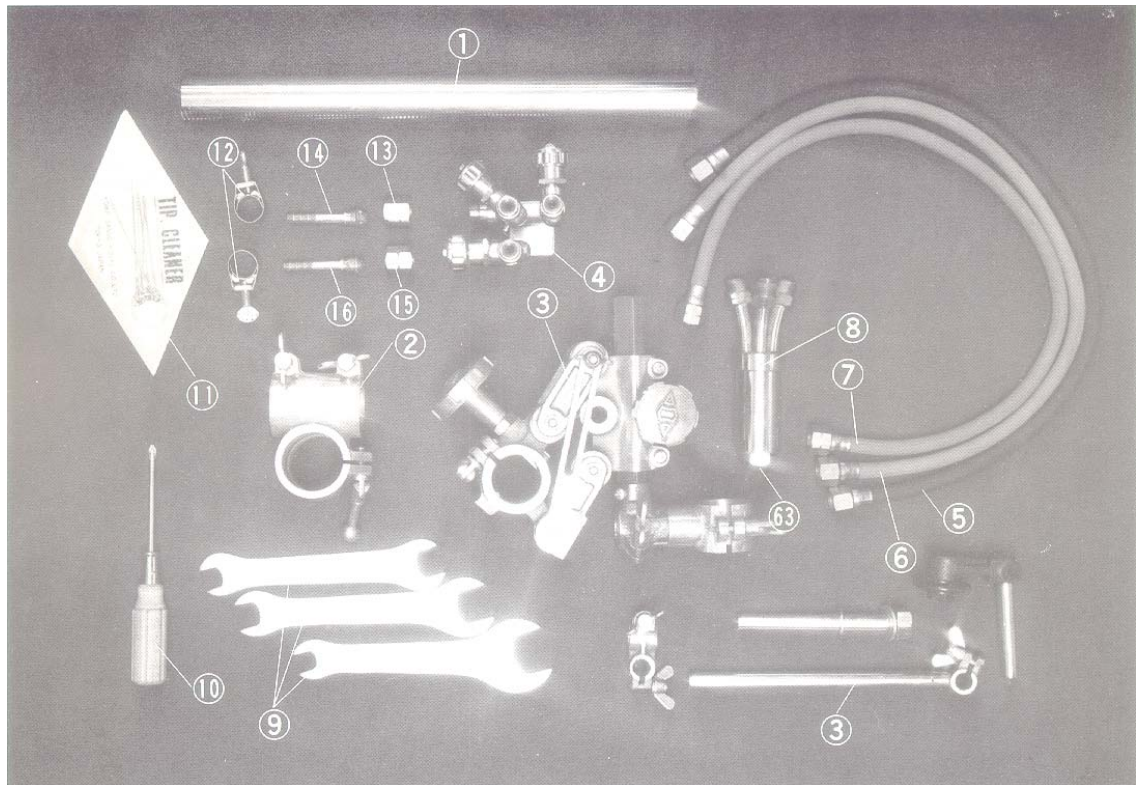

Item No	Part Name	Qty	Stock No	Remarks
1	Pipe arm	1	30300	Standard 350mm
2	Bar holder	1	30301	
3	Torch holder (A type)	1	30328	With guide roller
4	Distributor	1	13201	Except USA
			13202	USA Only
5	Hose (black) for jet oxygen	1	30303	Except USA
			30304	USA Only
6	Hose (blue) for preheat oxygen	1	30305	Except USA
			30306	USA Only
7	Hose (red) for gas	1	30307	Except USA
			30308	USA Only
8	Torch	1	10601	Except USA
			10602	USA Only
9	Spanner	1	30309	
10	Screw driver	1	30310	
11	Tip Cleaner	1	30311	
12	Hose band	2	30312	Except USA
13	Nut for oxygen	1	15001	Except USA M16.P1.5
14	Hose connector for oxygen	1	15003	Except USA 5/16
15	Nut for gas	1	15002	Except USA M16.P1.5.Right
16	Hose connector for gas	1	15004	Except USA 3/8

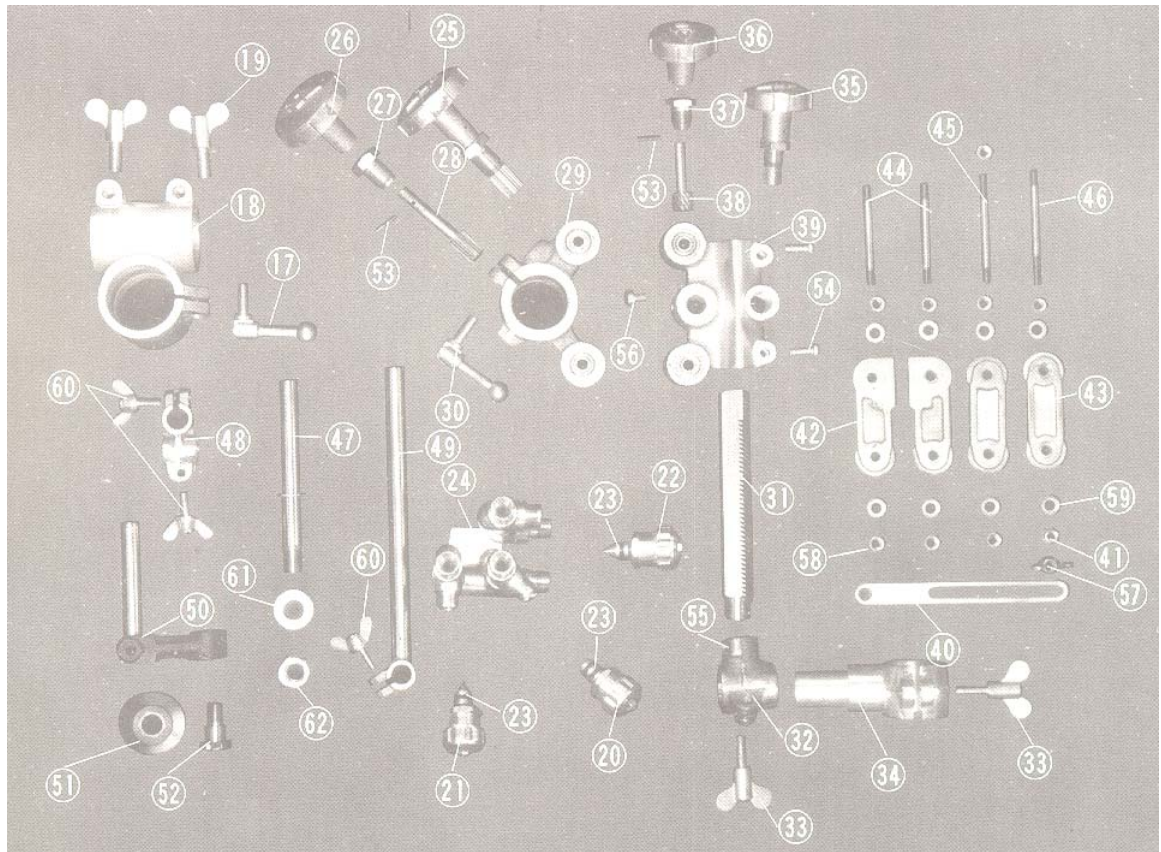

Item No	Part Name	Qty	Stock No	Remarks
17	Crank handle	1	30313	
18	Bar holder	1	30314	
19	Wing bolt	2	30315	
20	Valve for jet oxygen	1	15114	Old No. 00A01
21	Valve for preheat oxygen	1	15112	Old No. 00B01
22	Valve for gas	1	15113	Old No. 00C01
23	O-Ring		05026	
24	Distributor	1	13203	For Japan
			13204	For USA
25	Cross feed handle assembly	1	30316	
26	Handle	1	30317	
27	Pinion metal	1	30318	
28	Pinion	1	30319	
29	Cross feed holder	1	30329	
30	Crank handle	1	30313	
31	Slide bar	1	30390	
32	Torch holder base	1	30391	
33	Wing bolt	2	30392	
34	Torch holder	1	30393	
35	Up/down handle assembly	1	30394	
36	Handle	1	30223	
37	Pinion metal	1	30395	
38	Pinion	1	30396	
39	Up/down holder assembly	1	30330	
40	Set plate	1	30331	
41	Nut	1	30332	
42	Ling arm (A)	2	30333	
43	Ling arm (B)	2	30334	
44	Bearing shaft (A)	2	30335	
45	Bearing shaft (B)	1	30336	

Item No	Part Name	Qty	Stock No	Remarks
46	Bearing shaft (C)	1	30337	
47	Guide roller shaft (A)	1	30338	With stop ring
48	Guide roller holder base	1	30339	
49	Guide roller shaft (B)	1	30340	
50	Guide roller shaft assembly	1	30341	
51	Guide roller	1	30342	
52	Roller nut	1	30343	
53	Spring pin	2	PR-2.5X16	φ2.5x16
54	Screw	2	SP-6X18	M6x18
55	Screw	1	SP-6X14	M6x14
56	Hex bolt	1	BH-6X12	M6x12
57	Wing nut	1	NB-6	M6
58	Hex nut	8	NH-6	M6
59	Washer	8	WF-6	φ6
60	Wing bolt	3	BS-6X16	M6x16
61	Washer	1	WF-12	φ12
62	Hex nut	1	NH-12	M12
63	Tip fixing nut	1	05020	