

## Diagrams and Parts List

# IK-12MAX

Torch SP-300

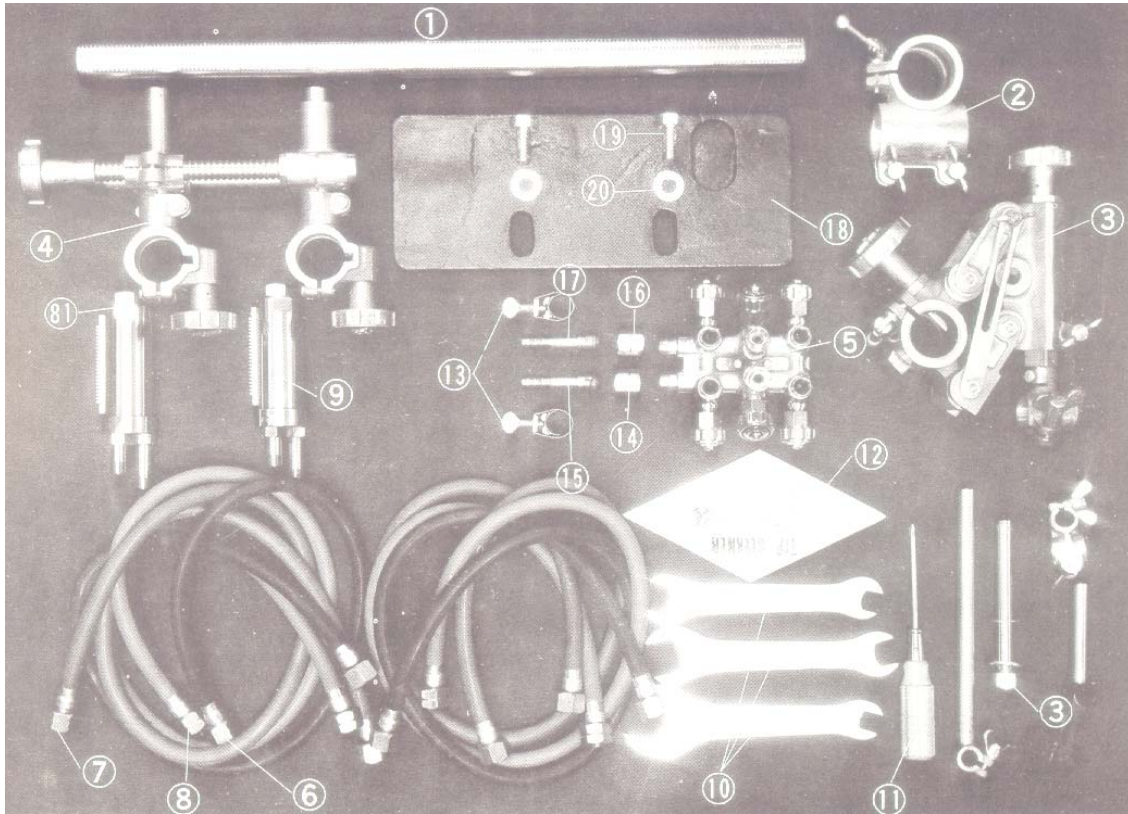

Item No	Part Name	Qty	Stock No	Remarks
1	Pipe arm	1	30321	Standard 500mm
2	Arm Holder	1	30301	
3	Torch holder (C type)	1	30344	
4	V-cutter holder	1	30345	
5	Distributor	1	13251	Except USA
			13252	USA Only
6	Hose for jet oxygen	2	30322	Except USA
			30323	USA Only
7	Hose for pre oxygen	2	30324	Except USA
			30325	USA Only
8	Hose for gas	2	30326	Except USA
			30327	USA Only
9	Torch	2	10651	Except USA
			10652	USA Only
10	Spanner	1	30309	
11	Screw driver	1	30310	
12	Tip cleaner	1	30311	
13	Hose band	2	30312	Except USA
14	Nut for oxygen	1	15001	Except USA M16.P1.5
15	Hose connector for oxygen	1	15003	Except USA 5/16"
16	Nut for gas	1	15002	Except USA M16.P1.5.Right
17	Hose connector for gas	1	15004	Except USA 3/8
18	Weight	1	30346	
19	Hex bolt	2	BH-10X35	M10x35
20	Washer	2	WF-10	φ10

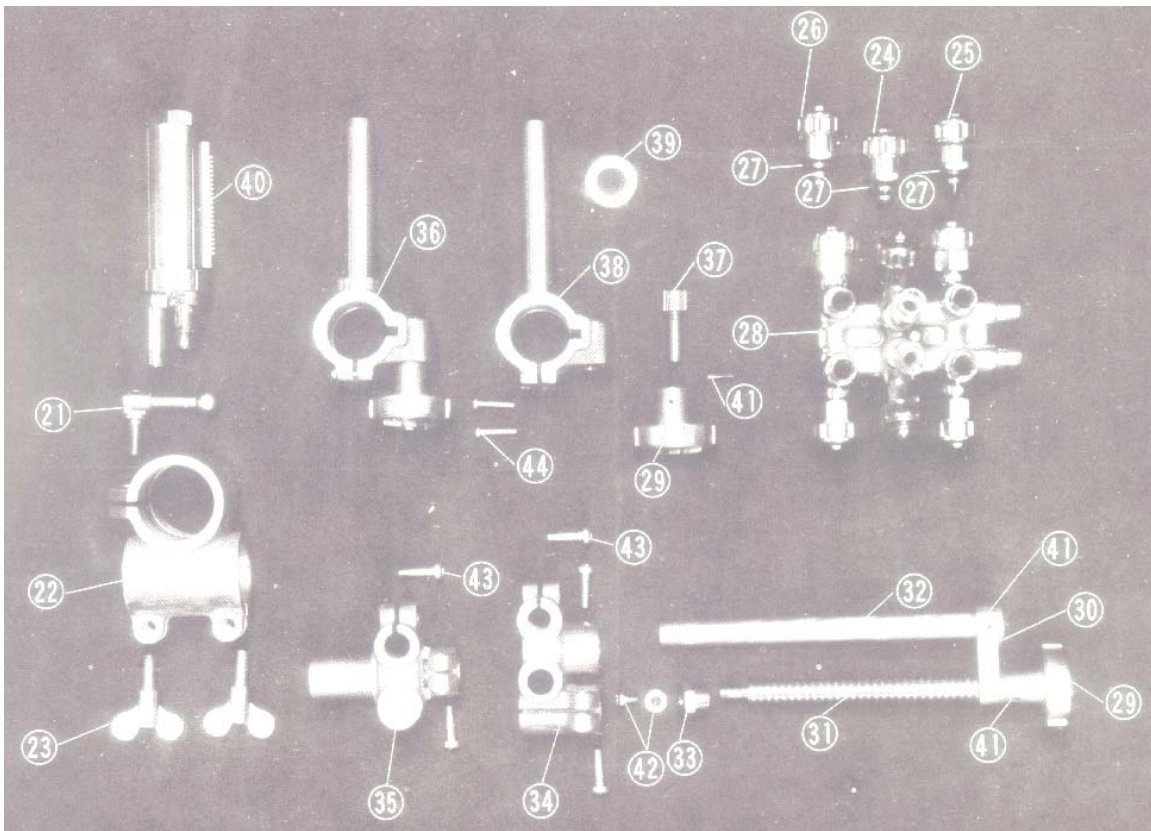

Item No	Part Name	Qty	Stock No	Remarks
21	Crank handle	1	30313	
22	Bar holder	1	30314	
23	Wing bolt	2	30315	
24	Valve for jet oxygen	2	15114	Old 00A01
25	Valve for pre oxygen	2	15112	Old 00B01
26	Valve for gas	2	15113	Old 00C01
27	O-Ring		05026	
28	Distributor body	1	13253	Except USA
			13254	USA Only
29	Handle	2	30223	
30	Screw metal	1	30347	
31	Screw	1	30348	
32	Guide bar	1	30349	
33	Bush	1	30350	
34	Torch slide base	1	30351	
35	Torch holder bracket	1	30352	
36	Torch holder assembly	2	30353	
37	Pinion	2	30354	
38	Torch holder	2	30355	
39	Graduation collar	2	30356	With screw
40	Torch rack	2	10653	With screw
41	Spring pin	4	PR-2.5X16	φ2.5x16
42	Screw	1	SP-5X8	With washer, M5x8
43	Screw	5	SP-6X18	M6x18
44	Screw	4	SP-4X18	M4-18

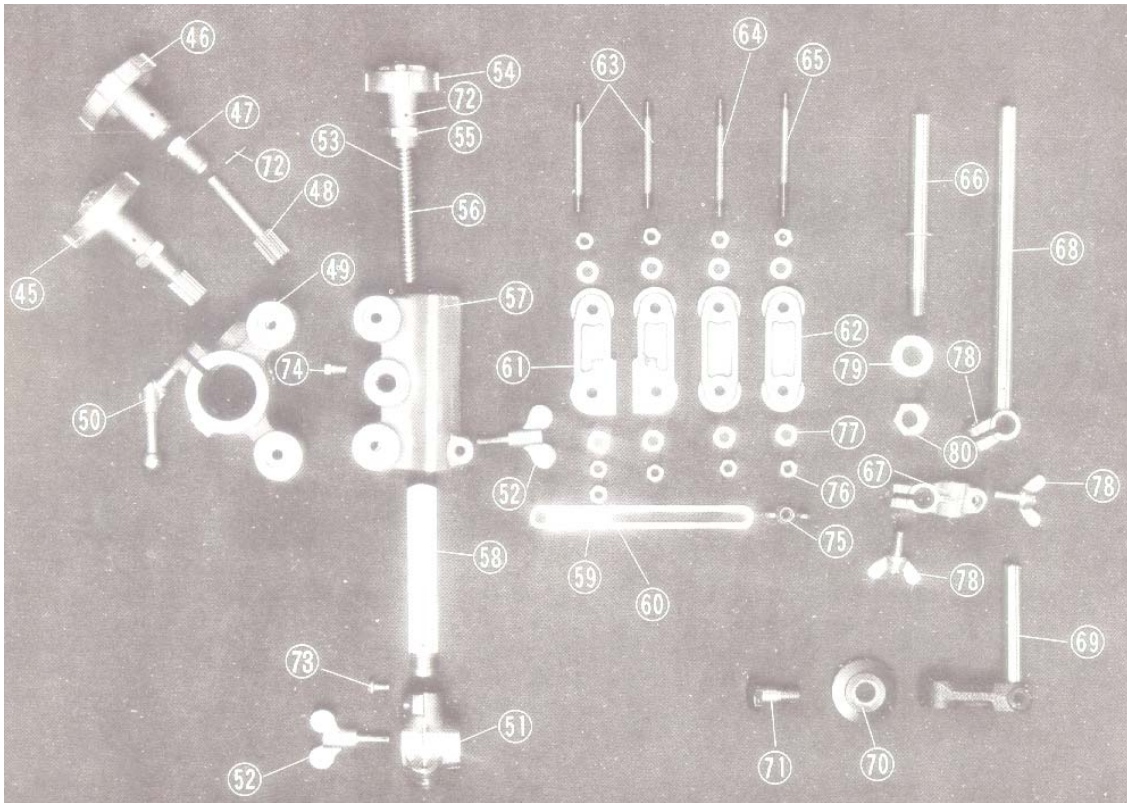

Item No	Part Name	Qty	Stock No	Remarks
45	Crossfeed handle assembly	1	30316	
46	Handle	1	30317	
47	Pinion metal	1	30318	
48	Pinion	1	30319	
49	Crossfeed table holder	1	30329	
50	Crank handle	1	30313	
51	Torch holder bracket	1	30391	
52	Wing bolt	2	30392	
53	Up/down handle assembly	1	30357	
54	Handle	1	30223	
55	Screw metal	1	30358	
56	Screw	1	30359	
57	Up/down holder assembly	1	30360	
58	Slide bar	1	30361	
59	Fixing plate	1	30331	
60	Hex nut	1	30332	
61	Link arm (A)	2	30333	
62	Link arm (B)	2	30334	
63	Bearing shaft (A)	2	30335	
64	Bearing shaft (B)	1	30336	
65	Bearing shaft (C)	1	30337	
66	Guide roller fixing shaft (A)	1	30338	With stop ring
67	Guide roller holder	1	30339	
68	Guide roller shaft (B)	1	30340	
69	Guide roller shaft assembly	1	30341	
70	Guide roller	1	30342	
71	Roller nut	1	30343	
72	Spring pin	2	PR-2.5X16	φ2.5x16
73	Screw	1	SP-6X14	M6x14
74	Hex bolt	1	BH-6X12	M6x12
75	Wing nut	1	NB-6	M6
76	Hex nut	8	NH-6	M6
77	Washer	8	WF-6	φ6
78	Wing bolt	3	BS-6X16	M6x16
79	Washer	1	WF-12	φ12
80	Hex nut	1	NH-12	M12
81	Tip fixing nut	1	05020	