

IK-12 NEXT™

Portable Welding and Gas/Plasma Cutting Machine

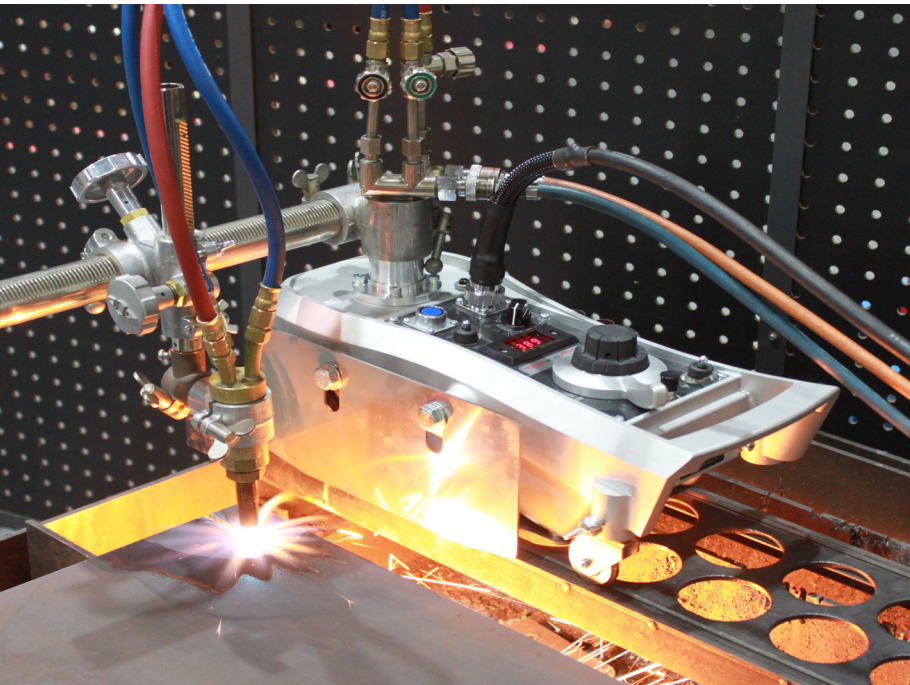

IK-12 NEXT is the latest model of straight line cutting & welding carriages

Designed to replace the rugged IK-12 Max3, one of the most popular and longest selling cutting carriages in the fabrication industry.

The IK-12 NEXT is an incredibly strong, versatile tractor that is specifically designed to be compatible with most applications. With the ability to adapt to each process, the machine is versatile but still retains a simplistic operating system.

Features & Benefits

- **Multi-function control panel**
The new digital control panel enables the operator to accurately set a wide range of parameters as they relate to each process. With the use of a LCD display, set-up time is greatly reduced and made more repeatable.
- **Powertrain**
Allows for extremely accurate positioning and ensures continuous drive speed and pulling force that is not compromised by power fluctuations or varying load weight.
- **Multi-purpose cutting and welding**
The machine comes standard with the ability to interface to most power sources. Whether cutting or welding, the IK-12 NEXT has a built-in control that will send command signals directly to an attached power source interlock switch.



Newly equipped with welding and plasma cutting capabilities

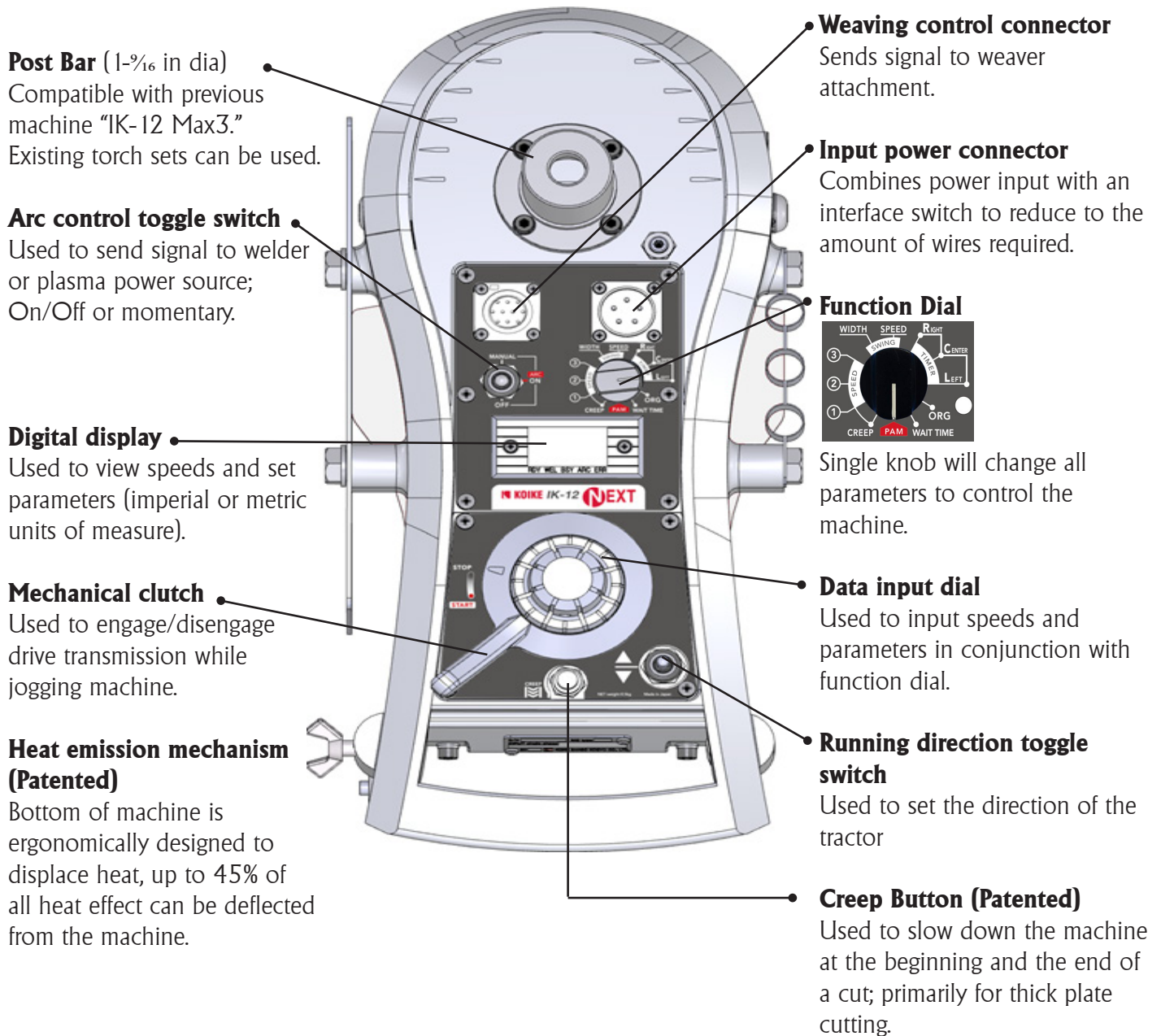

IK-12 NEXT Machine Kits

Oxy-fuel cutting torch set

| MODELS DESCRIPTIONS | PART# |
|---------------------|-------|
|---------------------|-------|

Standard one torch unit; commonly used for plate stripping or performing compound bevel work.

S-100 Set Acetylene Kit **NEXTS100102**
S-100 Set LPG Kit **NEXTS100106**

Each kit includes:

- (1) IK-12 NEXT Unit 20506283
- (1) S-100 Torch Set w/ Snap Valve BCG25001
- (1) 6 ft Rail ZM30400
- (3) Cutting Tips Sizes 0, 1, 2 ZTIP102# OR ZTIP106#
- (1) Safety-Z Coupling Set ZA3232260



Standard two torch unit; dual torch head commonly used for plate stripping or performing compound bevel work.

S-200 Set Acetylene Kit **NEXTS200102**
S-200 Set LPG Kit **NEXTS200106**

Each kit includes:

- (1) IK-12 NEXT Unit 20506283
- (1) S-200 (2) Torch Set ZA4052018
- (1) 6 ft Rail ZM30400
- (3) Cutting Tips Sizes 0, 1, 2 ZTIP102# OR ZTIP106#
- (1) Safety-Z Coupling Set ZA3232260



One torch unit with mechanical torch height control. Also allows same functions as above but includes a plate tracking system used to maintain accurate plate distance from workpiece and allows for more accurate beveling.

SP-100 Set Acetylene Kit **NEXTSP100102**
SP-100 Set LPG Kit **NEXTSP100106**

Each kit includes:

- (1) IK-12 NEXT Unit 20506283
- (1) SP-100 (1) Torch Set ZA4052019
- (1) 6 ft Rail ZM30400
- (3) Cutting Tips Sizes 0, 1, 2 ZTIP102# OR ZTIP106#
- (1) Safety-Z Coupling Set ZA3232260



| MODELS DESCRIPTIONS | PART# |
|---------------------|-------|
|---------------------|-------|

Two torch unit with mechanical torch height control on each torch unit. Allows same functions as S-200 but includes a plate tracking system used to maintain accurate plate distance from workpiece. Allows for more accurate beveling.

SP-200 Set Acetylene Kit **NEXT2P200102**
SP-200 Set LPG Kit **NEXTSP200106**

Each kit includes:

- (1) IK-12 NEXT Unit 20506283
- (1) SP-200 (2) Torch Set ZA4052020
- (1) 6 ft Rail ZM30400
- (3) Cutting Tips Sizes 0, 1, 2 ZTIP102# OR ZTIP106#
- (1) Safety-Z Coupling Set ZA3232260



Two torch unit with mechanical torch height control on a single tracking system. Commonly used for V-grooves or plate edge beveling; maintains angle of two torches for accurate Y & X bevel cuts.

SP-300 Set Acetylene Kit **NEXTSP300102**
SP-300 Set LPG Kit **NEXTSP300106**

Each kit includes:

- (1) IK-12 NEXT Unit 20506283
- (1) SP-300 (2) Torch Set ZA4052021
- (1) 6 ft Rail ZM30400
- (3) Cutting Tips Sizes 0, 1, 2 ZTIP102# OR ZTIP106#
- (1) Safety-Z Coupling Set ZA3232260

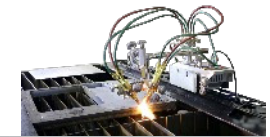

Triple torch on a single tracking system. Commonly used for maintaining angle of three torches for accurate Y, X, and K bevel cuts; used for heavy plate beveling.

SP-400 Set Acetylene Kit **NEXTSP400102**
SP-400 Set LPG Kit **NEXTSP400106**

Each kit includes:

- (1) IK-12 NEXT Unit 20506283
- (1) SP-400 (3) Torch Set ZA4052022
- (1) 6 ft Rail ZM30400
- (3) Cutting Tips Sizes 0,1,2 ZTIP102 OR ZTIP106, 0,1,2
- (1) Safety-Z Coupling Set ZA3232260

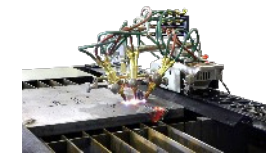

Heavy duty torch designed to cut up to 10 in (2540mm) plate thickness or where a large stand-off is needed.

300L Torch Kit **300LKIT**
 1/4 - 12 in (3-300mm) **NEXT300L102**
 with 100 series tips **NEXT300L106**

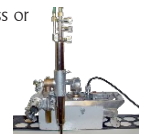

Welding

Torch set for butt welding

- **A type welding holder set** is a single torch clamp that will give torch angle and tilt in all directions.



- Allows torch to tilt +/- 45° for easy and accurate positioning.

NEXTWELD - WELDING KIT
 Requires Welding Mfg. remote pendant)

- Each kit includes:
- (1) Machine Unit 20506283
 - (1) Welding torch holder kit ZA4404110
 - (1) 6 ft Rail ZM30400

- **NEXTWEAVE - WEAVING KIT**

- Each kit includes:
- 1 - 20506283 Machine Unit
 - 1 - 20511065 Weaving/Welding Kit
 - 1 - ZM30400 - 6 ft rail

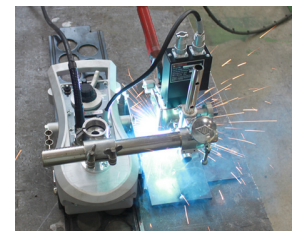

Plasma cutting

IK-12 NEXT has arc stablization inside, which allows for programmable piercing.

- **Plasma holder set** Allows torch to tilt +/- 45° for easy and accurate positioning.
- NEXTP - Plasma Kit**
 (Customer must provide plasma unit)

- Each kit includes:
- (1) Machine Unit 20506283
 - (1) Plasma torch holder kit 20511063
 - (1) 6 ft Rail ZM30400

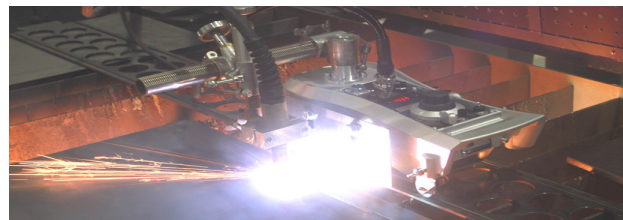

Accessories

Optional Accessories

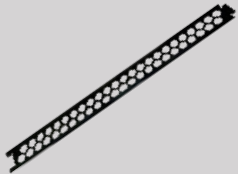

Standard rail 6 ft (1800mm)
Part#ZM30400

- Extendable 6 ft (1800mm) rail
- Built of special steel to ensure longevity
- Easy connection/no tools needed



Circle cutting rail

Part#BCD19109

- Cutting diameter:
 - Inside: \varnothing 1- $\frac{1}{16}$ - 14- $\frac{3}{16}$ in (40-360mm)
 - Outside: 30- $\frac{3}{16}$ - 45- $\frac{1}{4}$ in (770-1150 mm) with standard length cross bar.
- Counter weight recommended



Heavy-duty heat resistant rail 6 ft (1800mm)
Part#ZS30407

- Extendable, robust structure rail that does not bend.
- Recommended when cutting thick plate over 2 in (150mm)



Circle cutting attachment
Part#ZS31858

- Cutting diameter \varnothing 15- $\frac{3}{4}$ to 94- $\frac{1}{2}$ in (400-2400mm)



Vertical slide bar
Part#ZS30390 (6in); ZS30430 (10in); ZS30433 (16in)

- Extends torch up/down stroke, used when cutting from the side of plate.

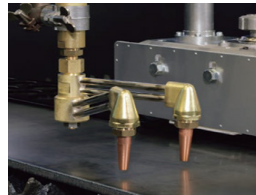

Twin torch attachment
Part#ZA3312001

- Enables 2-torch parallel cutting by attaching to a torch.
- Torch distance 1- $\frac{1}{16}$ - 11- $\frac{1}{16}$ in (30-300mm)



Snap Valve
Part#SNAPVALVEI: 1 torch
Part#SNAPVALVEII: 2 torches
Part#SNAPVALVEV: 300L Torch

- Single action gas on/off
- 2 models; single or two torches



Extended post bar
Part#60032374

- 11.8 in (300mm) long stand
- Allows torch head to raise above machine

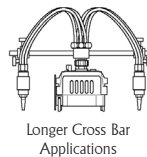

Longer Cross Bar Applications

| Cross Bars | Part# | |
|------------------|---------|--|
| 13.7 in (350mm) | ZS30300 | |
| 19.6 in (500mm) | ZS30321 | |
| 31.5 in (800mm) | ZS30424 | |
| 47.4 in (1200mm) | ZS30426 | |
| 98.4 in (2500mm) | ZS30429 | |



Torch bevel attachment
Part#3311001

- Accurate bevel cutting with angle indicator
- Cuts bevel without tilting the torch



Koike Aronson, Inc.

P.O. Box 307, Arcade, NY 14009

Phone (585) 492-2400 Fax (585) 457-3517

www.koike.com

IK-12 NEXT 06/19 KENG